

Modular Multiples®

The Original Multiple Light Family of Fixtures

Trimmed

Driver/Transformer Attached - Recessed - New/Old Work

For applications where ceilings are currently installed. An opening is cut into the ceiling material to fit the trimless mounting frame, which is secured with the appropriate hardware. Spackling compound is applied over the perforated flange and finished for a smooth appearance. Fixture wiring connections are made and fixture is inserted through the installed frame and sat in place on top of the frame and secured with provided hardware.

Four Light



MTRS-4-LED-512-20-27-2-TA-REC-AWNR-BL

Modular Multiples® Trimmed Series, four 12 watt LED modules, 2700°K, black housing, drivers/transformers attached, rectangular aperture, Lutron Athena Wireless Node-black configuration shown. Other configurations available.

[Download CSI drop-in spec template](#)

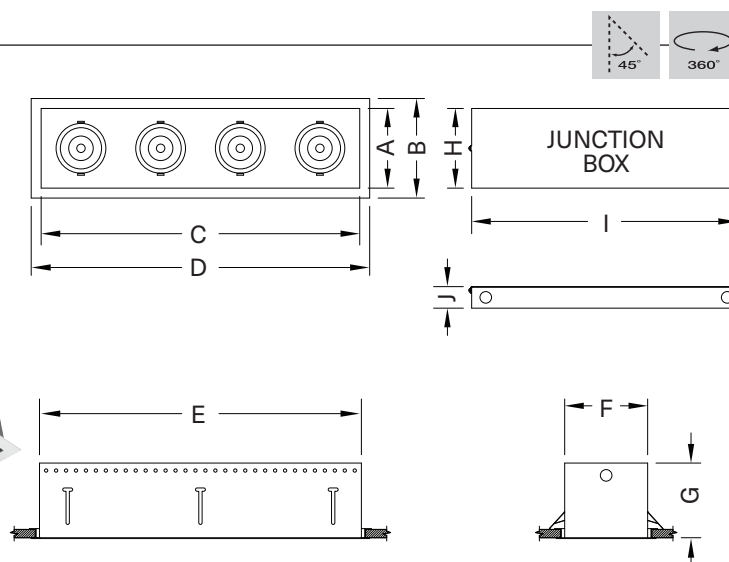

COMPATIBLE CEILING MATERIALS



| LAMPS and DIMENSIONS | A | B | C | D | E | F | G |
|---|-------------|-----------------|--------------|------------------|------------------|-----------------|-----------------|
| LED-507, LED-508, LED-510, LED-511, LED-512 | 5" 127mm | 6-1/2" 165mm | 20" 508mm | 21-1/2" 546mm | 20-1/4" 514mm | 5-1/4" 133mm | 5-5/8" 143mm |
| LED-712, LED-714, LED-716, LED-720, LED-920, LED-926, LED-929, LED-932, LED-935 | 6" 152mm | 7-1/2" 190mm | 24" 610mm | 25-1/2" 648mm | 24-1/4" 616mm | 6-1/4" 159mm | 5-5/8" 143mm |

Above measurements shown with 45° of adjustability. Certain driver options may alter housing dimensions. Contact factory for more details.

| JUNCTION BOX | H | I | J |
|--------------|-------------|--------------|----------------|
| | 6" 152mm | 20" 508mm | 1-5/8" 41mm |

Modular International, Inc.
1-412-734-9000
www.modularinternational.com



REV. 05/01/23

Modular Multiples®

The Original Multiple Light Family of Fixtures

Trimmed

Driver/Transformer Attached - Recessed - New/Old Work



Configurations: 1, 2, 3, 4 light sources standard, custom configurations available.

Housing:

- Fabricated 18 gauge steel supplied with adjustable mounting brackets.
- 14 gauge steel trim flange.

Finishes:

- Housing and ring sets powder coated – white or black standard.
- Custom colors available.
- Stainless steel/satin nickel available.

Electrical:

- One driver/transformer attached per light source for multi-circuit wiring.
- Phase, 0-10V, DALI-2, and DMX dimming options available. Please consult factory for available driver options.
- 120/277V available.
- Listed to UL1598 standards.

[Download CSI drop-in spec template](#)

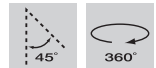

Light Sources: 579e LED Modules

| | | |
|------------|------------|------------|
| LED-507-20 | LED-712-20 | LED-920-35 |
| LED-507-30 | LED-712-30 | LED-920-45 |
| LED-507-40 | LED-712-40 | LED-920-60 |
| LED-508-20 | LED-712-55 | LED-920-90 |
| LED-508-30 | LED-714-20 | LED-926-35 |
| LED-508-40 | LED-714-30 | LED-926-45 |
| LED-510-20 | LED-714-40 | LED-926-60 |
| LED-510-30 | LED-714-55 | LED-926-90 |
| LED-510-40 | LED-716-20 | LED-929-35 |
| LED-511-20 | LED-716-30 | LED-929-45 |
| LED-511-30 | LED-716-40 | LED-929-60 |
| LED-511-40 | LED-716-55 | LED-929-90 |
| LED-512-20 | LED-720-20 | LED-932-35 |
| LED-512-30 | LED-720-30 | LED-932-45 |
| LED-512-40 | LED-720-40 | LED-932-60 |
| | LED-720-55 | LED-932-90 |
| | | LED-935-35 |
| | | LED-935-45 |
| | | LED-935-60 |
| | | LED-935-90 |

LED legacy light source replacements:

| | |
|-----------------|-----------------|
| MR16LED (-BLD) | PAR30LED (-GLD) |
| AR111LED (-DLD) | PAR38LED (-JLD) |

Mounting:

- For applications where ceilings are currently installed.
- An opening is cut into the ceiling material to fit the Mounting Frame.
- Housing connected to 18 gauge galvanized steel transformer/wiring section via 24" (610mm) flexible metal conduit
- Fixture wiring connections are made and fixture is inserted through the installed frame and secured with provided hardware

Options:

- Patented aluminum ring sets and locking devices.
- Pull down yokes.
- Filter rings and shielding cylinders.
- Filter media: up to two 1/8" (3mm) thick filter per light source.
- Lutron Athena Wireless Node (white or black finish available).

Model # example: MTRS-4-LED-512-20-27-2-TA-REC-AWNR-WH

example:

- Lutron Athena Wireless Node: White (-AWNR-WH), Black (AWNR-BL)
- Aperture: rectangular (REC), round (RD), square (SQ)
- Driver/transformer attached (TA), primary voltage (PV)
- Color: white (1), black (2), chrome (4), stainless steel (6), custom (x)
- Selected Kelvin temperature: 2700°K (27), 3000°K (30), 3500°K (35), 4000°K (40)
- Light sources: see above list
- Number of light sources
- Modular Multiples® Trimmed Series

Modular Multiples®

The Original Multiple Light Family of Fixtures

579e Available LED Modules



| Model Number | Watts | Beam Angle | CRI | Lumens | Lumens per watt |
|--------------|-------|------------|-----|--------|-----------------|
| LED-507-20 | 7 | 20° | 90+ | 798 | 114 |
| LED-507-30 | 7 | 30° | 90+ | 758 | 108 |
| LED-507-40 | 7 | 40° | 90+ | 761 | 109 |
| LED-508-20 | 8 | 20° | 90+ | 1,060 | 133 |
| LED-508-30 | 8 | 30° | 90+ | 988 | 124 |
| LED-508-40 | 8 | 40° | 90+ | 1,001 | 125 |
| LED-510-20 | 10 | 20° | 90+ | 1,245 | 125 |
| LED-510-30 | 10 | 30° | 90+ | 1,177 | 118 |
| LED-510-40 | 10 | 40° | 90+ | 1,189 | 119 |
| LED-511-20 | 11 | 20° | 90+ | 1,362 | 124 |
| LED-511-30 | 11 | 30° | 90+ | 1,289 | 117 |
| LED-511-40 | 11 | 40° | 90+ | 1,309 | 119 |
| LED-512-20 | 12 | 20° | 90+ | 1,458 | 122 |
| LED-512-30 | 12 | 30° | 90+ | 1,385 | 115 |
| LED-512-40 | 12 | 40° | 90+ | 1,407 | 117 |
| LED-712-20 | 12 | 20° | 90+ | 1,591 | 133 |
| LED-712-30 | 12 | 30° | 90+ | 1,580 | 132 |
| LED-712-40 | 12 | 40° | 90+ | 1,513 | 126 |
| LED-712-55 | 12 | 55° | 90+ | 1,557 | 130 |
| LED-714-20 | 14 | 20° | 90+ | 1,885 | 135 |
| LED-714-30 | 14 | 30° | 90+ | 1,858 | 133 |
| LED-714-40 | 14 | 40° | 90+ | 1,780 | 127 |
| LED-714-55 | 14 | 55° | 90+ | 1,834 | 131 |
| LED-716-20 | 16 | 20° | 90+ | 2,203 | 138 |
| LED-716-30 | 16 | 30° | 90+ | 2,174 | 136 |
| LED-716-40 | 16 | 40° | 90+ | 2,080 | 130 |
| LED-716-55 | 16 | 55° | 90+ | 2,149 | 134 |
| LED-720-20 | 20 | 20° | 90+ | 2,650 | 133 |
| LED-720-30 | 20 | 30° | 90+ | 2,583 | 129 |
| LED-720-40 | 20 | 40° | 90+ | 2,462 | 123 |
| LED-720-55 | 20 | 55° | 90+ | 2,554 | 128 |
| LED-920-35 | 20 | 35° | 90+ | 3,028 | 151 |
| LED-920-45 | 20 | 45° | 90+ | 2,993 | 150 |
| LED-920-60 | 20 | 60° | 90+ | 3,019 | 151 |
| LED-920-90 | 20 | 90° | 90+ | 3,112 | 156 |
| LED-926-35 | 26 | 35° | 90+ | 3,868 | 149 |
| LED-926-45 | 26 | 45° | 90+ | 3,813 | 147 |
| LED-926-60 | 26 | 60° | 90+ | 3,871 | 149 |
| LED-926-90 | 26 | 90° | 90+ | 3,985 | 153 |
| LED-929-35 | 29 | 35° | 90+ | 4,264 | 147 |
| LED-929-45 | 29 | 45° | 90+ | 4,190 | 144 |
| LED-929-60 | 29 | 60° | 90+ | 4,272 | 147 |
| LED-929-90 | 29 | 90° | 90+ | 4,406 | 152 |
| LED-932-35 | 32 | 35° | 90+ | 4,645 | 145 |
| LED-932-45 | 32 | 45° | 90+ | 4,575 | 143 |
| LED-932-60 | 32 | 60° | 90+ | 4,652 | 145 |
| LED-932-90 | 32 | 90° | 90+ | 4,819 | 151 |
| LED-935-35 | 35 | 35° | 90+ | 5,034 | 144 |
| LED-935-45 | 35 | 45° | 90+ | 4,986 | 142 |
| LED-935-60 | 35 | 60° | 90+ | 5,095 | 146 |
| LED-935-90 | 35 | 90° | 90+ | 5,224 | 149 |

Modular Multiples®

The Original Multiple Light Family of Fixtures

Fixture Options

Extendable Yokes

ADD -EY TO END OF MODEL NUMBER

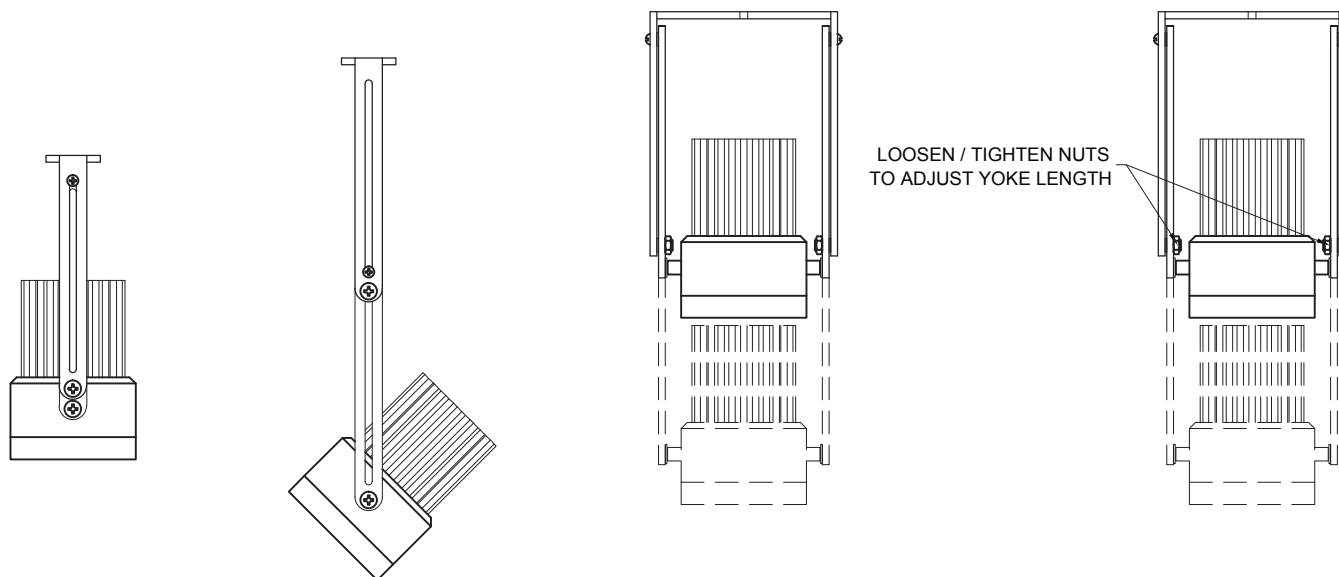

Shielding Options

ADD SHIELDING OPTION CODE (BELOW) TO END OF MODEL NUMBER

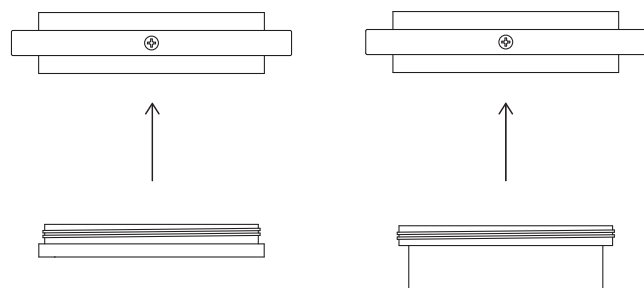

FILTER RING (STANDARD)

SHIELDING CYLINDER (-CY)

Lutron Athena Wireless Nodes



ATHENA WIRELESS NODE
WHITE (AWN-WH)



ATHENA WIRELESS NODE
BLACK (AWN-BL)

Filter Media

ADD FILTER MEDIA CODE (BELOW) TO END OF MODEL NUMBER

CLEAR GLASS (-CG)

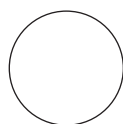

DIFFUSING SPREAD (-DS)

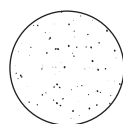

SATIN ETCHED (-SE)

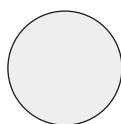

HEXCELL LOUVER (-HL)

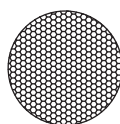

LINEAR SPREAD (-LS)

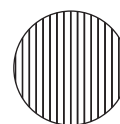

PRISMATIC WIDE SPREAD (-PS)

